

How to install Flowplan® Beam 4.0 & Flowmeter 2.0

STEP 1.

Install the Flowmeter 2.0 on the water filter using the included silicone seal

- Be aware of the direction of the flowmeter indicated by the arrow (both 3/8" and 3/4" flowmeters have the same flow direction).
- Don't over-tighten the connection as this may damage the seal.
- Use 3/8" flowmeters for low-flow installations such as espresso machines and crushed ice cube machines.
- Use 3/4" flowmeters for high-flow installations such as dishwashing machines and regular ice cube machines.
- All flowmeters must be installed horizontally like indicated on the illustration!

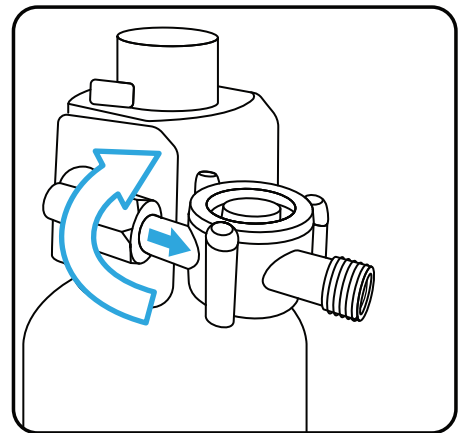
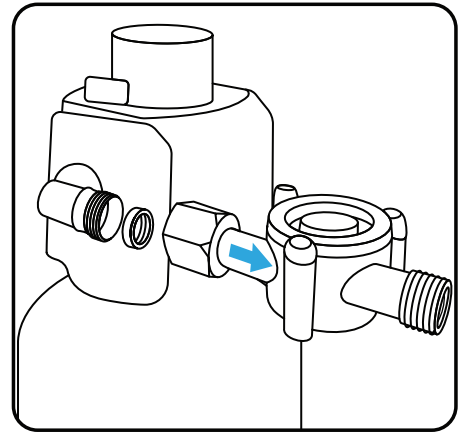

STEP 2.

Install the included antenna on the middle connector of the Beam by finger tightening it

- If the Beam is installed in a location with poor connection, you can install an extended antenna. Contact your sales representative for inquiries.

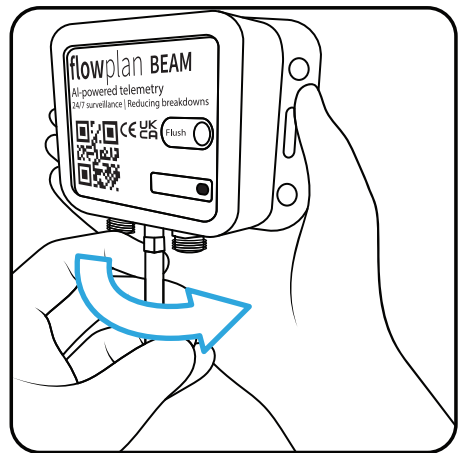

STEP 3.

Mount the Beam with zip ties or screws (not included)

- Avoid placing the beam in a metal cabinet or behind other potential signal disturbances.
- Place the Beam as high and in the open as possible.

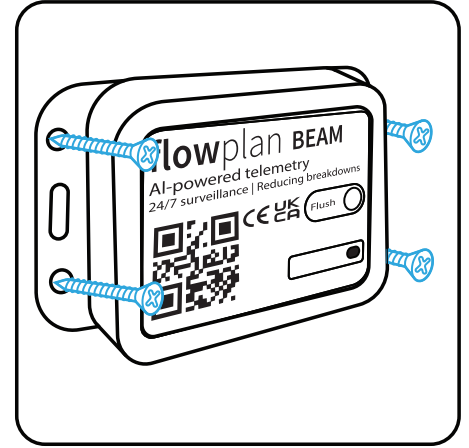
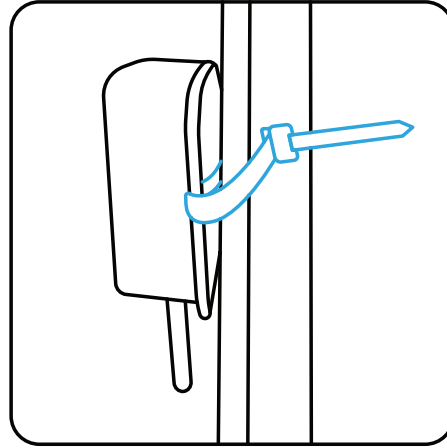

STEP 4.

Connect the flowmeter to the Beam

- Connect the flowmeter's connector to the right-most connector on the Beam (cannot be inserted incorrectly).
 - The M8 connector should only be finger-tightened.
- TIP: The small pin on the bottom of the flowmeter's plastic connector indicates the correct orientation at insertion.

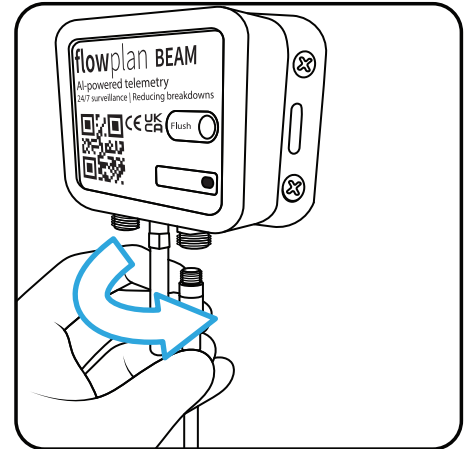

STEP 5.

Wait for the 4 beeps and blinks

- Connecting the flowmeter automatically starts the network search. 1 beep and blink indicates the Beam is turned on.
- The Beam beeps and blinks 4 times when connected to the network (approx 30s).
- If the beam does not connect after waiting up to 6 minutes. Please contact Flowplan® support on +45 4411 0800 or support@flowplan.dk.

